

The CR model knife gate valve is a wafer type valve designed for difficult applications. This valve is generally suitable for recycling applications, such as junk or sand traps of pulpers, high density cleaners (HDC) or as silo outlet with solid material. The two piece body with round inlet and square outlet (larger than the inlet) ensures non-jamming

Product description:

- Uni-directional wafer type knife gate valve
- Size range of DN100-600 (larger sizes upon request). See Dimension Charts for pressure rating
- Standard flange connection: DIN PN10 (EN 1092-2) and ANSI B16.5 (class 150) (on valve inlet only). Others available upon request
- Square-to-round transition pieces on the outlet available
- Double-acting pneumatic actuation
- Directives: 2006/42/EC (MACHINES), 2014/68/EU (PED) Fluid: Group 1(b), 2 (Cat. I. mod. A) and 2014/34/EU (ATEX)

Features:

- Internally machined two-part bolted cast body with internal replaceable gate guides for smoother gate traveling
- The square outlet prevents the build-up of contaminants such as staples, wires, etc
- Duplex gate for increased wear resistance polished both sides to avoid jamming and seat damage
- Easily replaceable high resistant long-lasting polyurethane seat with stainless steel core or bronze seat
- Long-life multiple graphite impreg. PTFE/aramid yarn combination with elastomeric core and EPDM o-ring, packing with easy access and adjustable gland follower. Wide range of materials available
- RAL-5015 blue epoxy-coating on all cast iron/carbon steel components
- Automated valves provided with gate guards in accordance with EU Safety Standards
- Other options: flush ports, vortex breakers on seating ring, special materials, fabricated valves, etc.
- Actuation accessories: limit & proximity switches, mechanical stops, positioners, solenoid valves, manual overrides, locking devices and fail safe systems

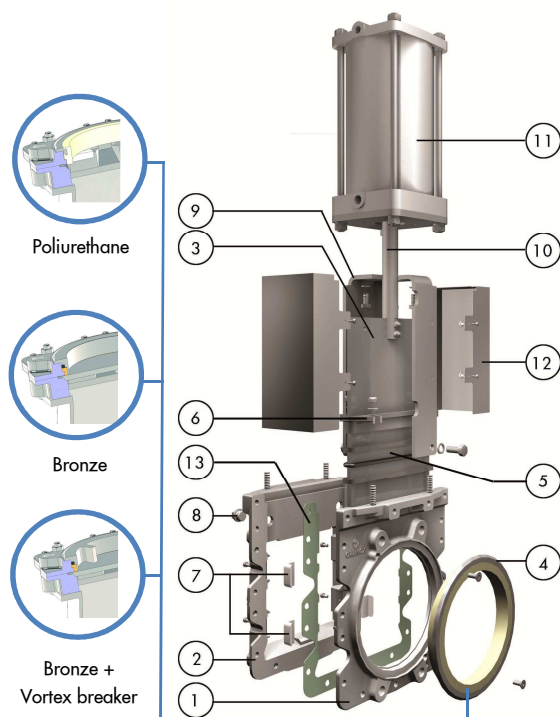

STANDARD PARTS LIST

Part	Materials
1 Body	GJL250 (0.6025) / CF8M (1.4408)
2 Body	GJL250 (0.6025) / CF8M (1.4408)
3 Gate	2205 (1.4462)
4 Seat	Polyurethane sleeve/ Bronze + AISI 316 ring
5 Packing	Dynapack + EPDM O-ring
6 Gland Follower	CF8M
7 Sliders	HWMPE
8 Cap	Galv. steel / AISI 316 (1.4404)
9 Yoke	Carbon steel - Epoxy coated
10 Piston Rod	AISI 304 (1.4301)
11 Cylinder	Aluminium
12 Gate Guards	AISI 304 (1.4301)
13 Gasket	Aramid fibres

DIMENSIONS (mm) Pneumatic Actuator (D/A)

DN	Pressures	A	B	C	D	E	F	G	H	I	O	P	Weight (kg.)	Std.Cyl.	Connect.
100	7 bar	52	206	100	140	198	231	110	569	115	95	97	35	C100/115	1/4"G
150	7 bar	60	252	108	175	237	296	130	708	140	145	146	78	C125/168	1/4"G
200	7 bar	60	315	123	205	309	358	168	872	175	194	194	89	C160/220	3/8"G
250	7 bar	69	388	185	250	376	428	194	1054	220	245	247	100	C200/270	3/8"G
300	7 bar	78	428	185	290	426	478	232	1194	220	294	298	145	C200/320	3/8"G
400	7 bar	89	560	270	392	574	599	292	1565	277	398	398	268	C250/425	3/8"G
500	4 bar	114	647	270	450	675	730	339	1855	382	499	479	370	C300/525	1/2"G
600	4 bar	114	747	270	510	775	830	397	2115	382	600	578	507	C300/625	1/2"G

