

TRANSMITTER ISOLATION VALVE

ORBINOX KP valve provides isolation of an level instrument transmitter from a storage tank. The installation of this valve allows the replacement of the transmitter or its maintenance without disrupting the process or draining the vessel

Product description

- Uni-directional wafer type knife gate valve
- Size: DN 80
- Non rising stem
- Standard flange connection pipe side: EN-1092 PN10 and ASME B16.5 (class 150). Tank side: see Main Dimensions
- Actuated by ratchet handle
- For EU Directives and other Certificates, please see the document: Directives and Certificates Compliance - Knife Gate Valves - Catalogues and Datasheets

Features

- Wafer style cast stainless steel monoblock body with raised faces and internal cast in gate wedges and guides for tighter shut-off
- Full port design for greater flow capacity and minimal pressure drop
- Stainless steel gate polished both sides to avoid jamming and seat damage
- Standard EPDM seat, also available in other materials (PTFE,...) with cast stainless steel seat ring, easily replaceable, that mechanically locks the seal. Deflection cones available
- Long-life multiple graphite impreg. PTFE/aramid yarn combination with elastomeric core, EPDM O-ring, packing with easy access and adjusting gland follower. Wide range of materials available

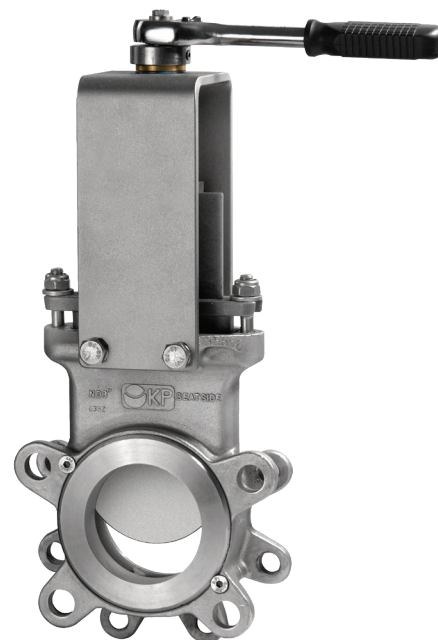

STANDARD PARTS LIST

Part	Description
1	Body CF8M
2	Gate AISI 316
3	Seat EPDM
4	"K" Ring AISI 316
5	Packing Dynapack (Graphite impregnated PTFE and Aramid yarn combination with an elastomeric core)+ (EPDM O-ring)
6	Gland follower CF8M
7	Stem nut Brass
8	Stem Stainless Steel
9	Yoke AISI 304
10	Axial fixing bush AISI 304
11	Friction washer PET + solid lubricant
12	Bushing Bronze
13	Spring Pin AISI 420 (ISO 8752)
14	Ratchet wrench Carbon steel
15	Bolts & Nuts A2

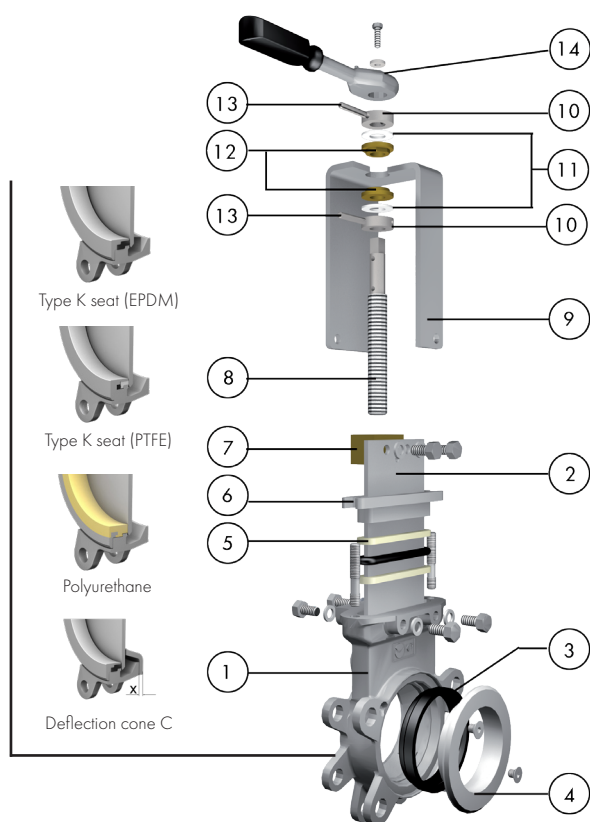

MAIN DIMENSIONS

	DN	Pressure	A	B	C	D	E	F	G	H	K
PN10	80	10 bar	51	177	110	22	88	212	120	325	160
ASME class 150	80	10 bar	51	180	110	22	74	212	120	325	152,4

	PN10		ASME class 150		TANK SIDE	
	M1	N1	M3	N3	ØM2	N2
PN10	M16	8	-	-	18	4
ASME class 150	-	-	5/8-11 UNC	4	18	4

