

THROUGH CONDUIT KNIFE GATE VALVE

The TH model knife gate is a bi-directional high pressure wafer valve designed for media with high consistency. The double seat design assures a non-clogging shut off on either normal or reverse flow. The valve is used in a wide range of demanding applications in industries such as:

- Pulp and Paper
- Wastewater treatment plants
- Chemical plants
- Power plants
- Etc.

Product description

- Bi-directional wafer type through-conduit high pressure knife gate valve
- Size range of DN 200-1000 (larger sizes available upon request)
- Design pressure up to 20 bar (other design pressures available upon request)
- Rising & non-rising stem configurations available
- Standard flange connection: EN-1092 PN10/16/25 and ASME B16.5 (class 150). Others flange connections available upon request
- Manual (bevel gear), pneumatic (single and double-acting), electric and hydraulic actuation options available
- For EU Directives and other Certificates, please see the document: Directives and Certificates Compliance - Knife Gate Valves - Catalogues and Datasheets

Features

- Wafer type fabricated or cast two-part bolted stainless steel body with internal HMWPE sliders for a smoother gate traveling
- Full port design for greater flow capacity and minimal pressure drop
- Stainless steel o-port design through-going gate, polished both sides to avoid jamming and seat damage
- Cast stainless steel seat ring, easily replaceable, that mechanically locks the seal. Standard EPDM seat, also available in other materials (PTFE,...). Metal-to-metal seat and deflection cones available
- Dual packing with easy access and adjustable packing glands. Long life multiple graphite imp. PTFE & aramid yarn combination with elastomeric core and EPDM o-ring. Wide range of materials available
- Automated valves provided with gate guards in accordance with EU Safety Standards
- Other options: bonnets, flush ports, special materials, fabricated valves, etc.
- Actuation accessories: limit & proximity switches, mechanical stops, positioners, solenoid valves, manual overrides, locking devices, fail safe systems, stem extensions and floor stands

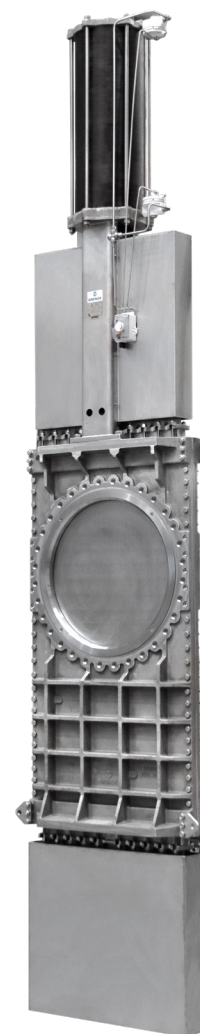

STANDARD PARTS LIST

Part	Stainless Steel
1 Body	CF8M / AISI 316
2 Body	CF8M / AISI 316
3 Gate	AISI 316
4 Seat	PTFE
5 "K" Ring	AISI 316
6 Packing	Dynapack (Graphite impregnated PTFE and Aramid yarn combination with an elastomeric core) + (EPDM O-ring)
7 Gland follower	CF8M / AISI 316
8 Yoke	AISI 304
9 Piston rod	AISI 304
10 Cylinder	Aluminum
11 Gate guards	AISI 304

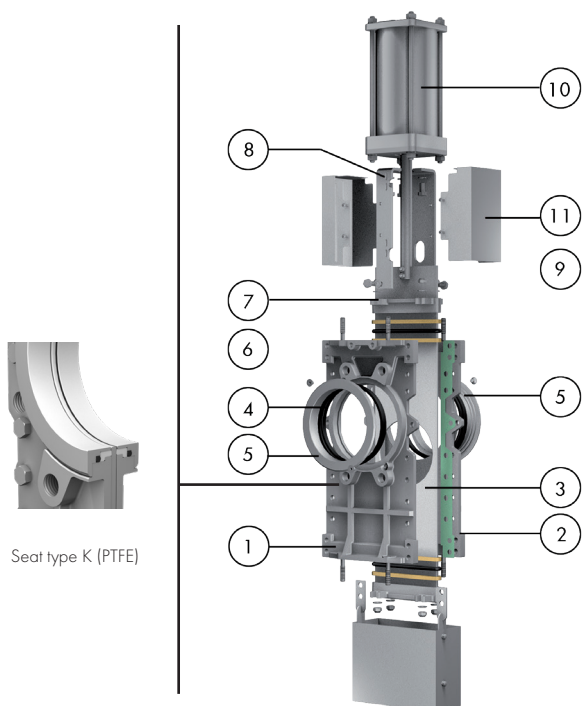

Bevel Gear Non Rising Stem

DN	X	A	ØB	H	O max.
300	302	78	310	822	905
350	332	78	410	897	1047
400	380	89	410	997	1171
450	420	89	550	1120	1301
500	490	114	550	1210	1575
600	540	122	550	1389	1711
700	665	128	650	997	2005
800	760	128	650	1120	2295
900	880	128	650	1210	2585
1000	970	128	650	1389	2875

NOTE: DN300-800 dimensions for 10 bar design pressure and PN10 flange drilling and DN900-1000 for 6 bar design pressure and PN10 flange drilling

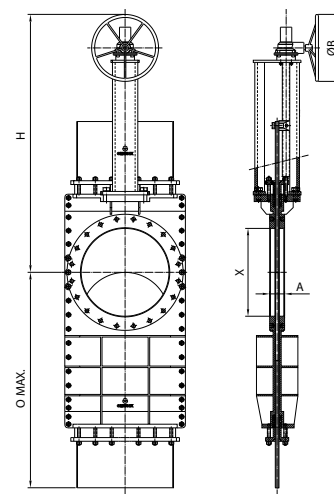

Bevel Gear Rising Stem

DN	X	A	ØB	H	O max.
300	302	78	310	1102	905
350	332	78	410	1286	1047
400	380	89	410	1386	1171
450	420	89	550	1583	1301
500	490	114	550	1673	1575
600	540	122	550	1963	1171
700	665	128	650	2300	2005
800	760	128	650	2640	2295
900	880	128	650	2980	2585
1000	970	128	650	3310	2875

NOTE: DN300-800 dimensions for 10 bar design pressure and PN10 flange drilling and DN900-1000 for 6 bar design pressure and PN10 flange drilling

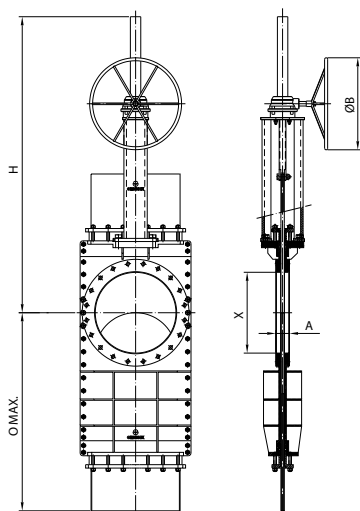

Pneumatic Cylinder

DN	X	A	O max.	B	H	Connect.
300	302	78	905	220	1172	3/8" G
350	332	78	1047	277	1344	3/8" G
400	380	89	1171	277	1494	3/8" G
450	420	89	1301	382	1693	1/2" G
500	490	114	1575	382	1959	1/2" G
600	540	122	1711	444	2206	3/4" G
700	665	128	1820	444	2485	3/4" G
800	760	128	1930	444	2775	3/4" G
900	880	128	2040	444	3080	3/4" G
1000	970	128	2135	444	3390	3/4" G

NOTE: DN300-800 dimensions for 10 bar design pressure and PN10 flange drilling and DN900-1000 for 6 bar design pressure and PN10 flange drilling

